



RECORD OF TITLE
UNDER LAND TRANSFER ACT 2017
FREEHOLD
Search Copy



R.W. Muir
Registrar-General
of Land

Identifier **NA1806/89**
Land Registration District **North Auckland**
Date Issued 27 January 1960

Prior References

NA1002/292 NA1035/245

Estate Fee Simple
Area 798 square metres more or less
Legal Description Part Lot 1-3 Deposited Plan 37794
Registered Owners
Eby Eapen Mathew and Shany Mary Abraham

Interests

Subject to a drainage right (in gross) in favour of The Waitemata County Council created by Transfer 489841 (affects part Lot 1 DP 37794)
Fencing Agreement in Transfer 496747 (affects part Lot 1 DP 37794)
13108599.3 Mortgage to ASB Bank Limited - 18.9.2024 at 1:36 pm

Statement of Passing over Information:

This information has been supplied by a third party. Accordingly, the Vendor and Austar Realty Limited are merely passing over this information as supplied to us by others. While we have passed on this information supplied by a third party, we have not checked, audited or reviewed the records or documents and therefore to the maximum extent permitted by law neither the Vendor nor Austar Realty Limited or any of its' salespersons or employees accept any responsibility for the accuracy of the materials. Intending purchasers are advised to conduct their own investigation.

VI Titirangi S.D.

798m²

Area amended as shown
in Red.

A.L.R.
9.3.60

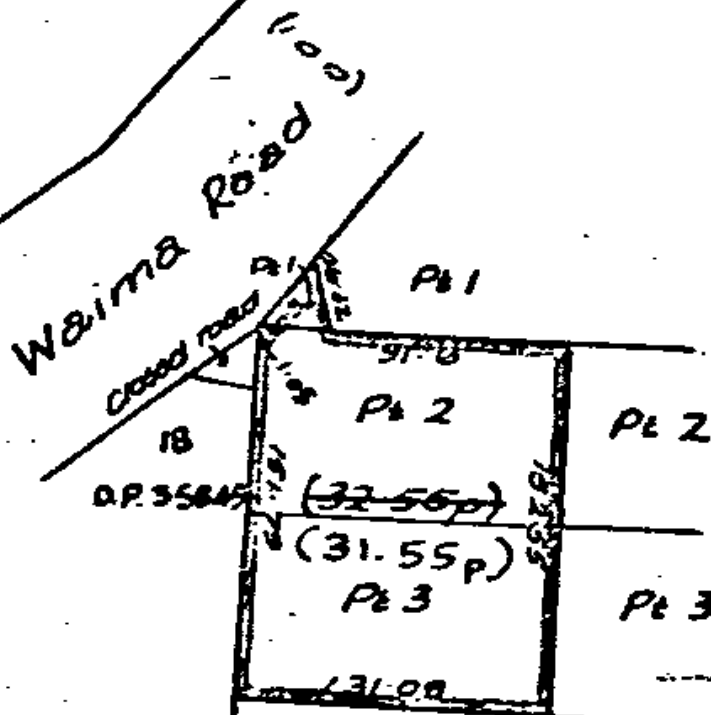

correct area
31.55 p.

Scale: 1 Chain to an inch.

del. J.F.

N 4 R N

9
0
J
1