



**RECORD OF TITLE
UNDER LAND TRANSFER ACT 2017
CROSS LEASE**

Search Copy



R.W. Muir
Registrar-General
of Land

Identifier **NA123C/784**
Land Registration District **North Auckland**
Date Issued 09 April 1999
Prior References
 NA118D/616 NA7C/845

STATEMENT OF PASSING OVER INFORMATION:

This information has been supplied to us by a third party. Accordingly, the Vendor and Austar Realty Limited are merely passing over this information as supplied to us by others. While we have passed on this information supplied by a third party, we have not checked, audited, or reviewed the records or documents and therefore to the maximum extent permitted by law neither the Vendor nor Austar Realty Limited or any of its' salespersons or employees accept any responsibility for the accuracy of the materials. Intending purchasers are advised to conduct their own investigation.

Estate Fee Simple - 1/2 share
Area 812 square metres more or less
Legal Description Lot 1 Deposited Plan 41783

Registered Owners

Craig Robert Murphy as to a 1/2 share
 Alexandra Lee Main as to a 1/2 share

Estate	Leasehold	Instrument	L D376011.4
		Term	999 years commencing on 1 March 1999

Legal Description Flat 2 Deposited Plan 194095

Registered Owners

Craig Robert Murphy as to a 1/2 share
 Alexandra Lee Main as to a 1/2 share

Interests

- D304865.3 Lease of Flat 1 DP 188970 CT NA118D/616 issued (Affects Fee Simple)
- D376011.3 Variation of Lease D304865.3 - 9.4.1999 at 2.20 pm (Affects Fee Simple)
- D376011.4 Lease of Flat 2 DP 194095 Term 999 years commencing on 1 March 1999 Composite CT NA123C/784 issued - 9.4.1999 at 2.20 pm (Affects Fee Simple)
- 11909944.3 Mortgage to Kiwibank Limited - 5.11.2020 at 3:23 pm

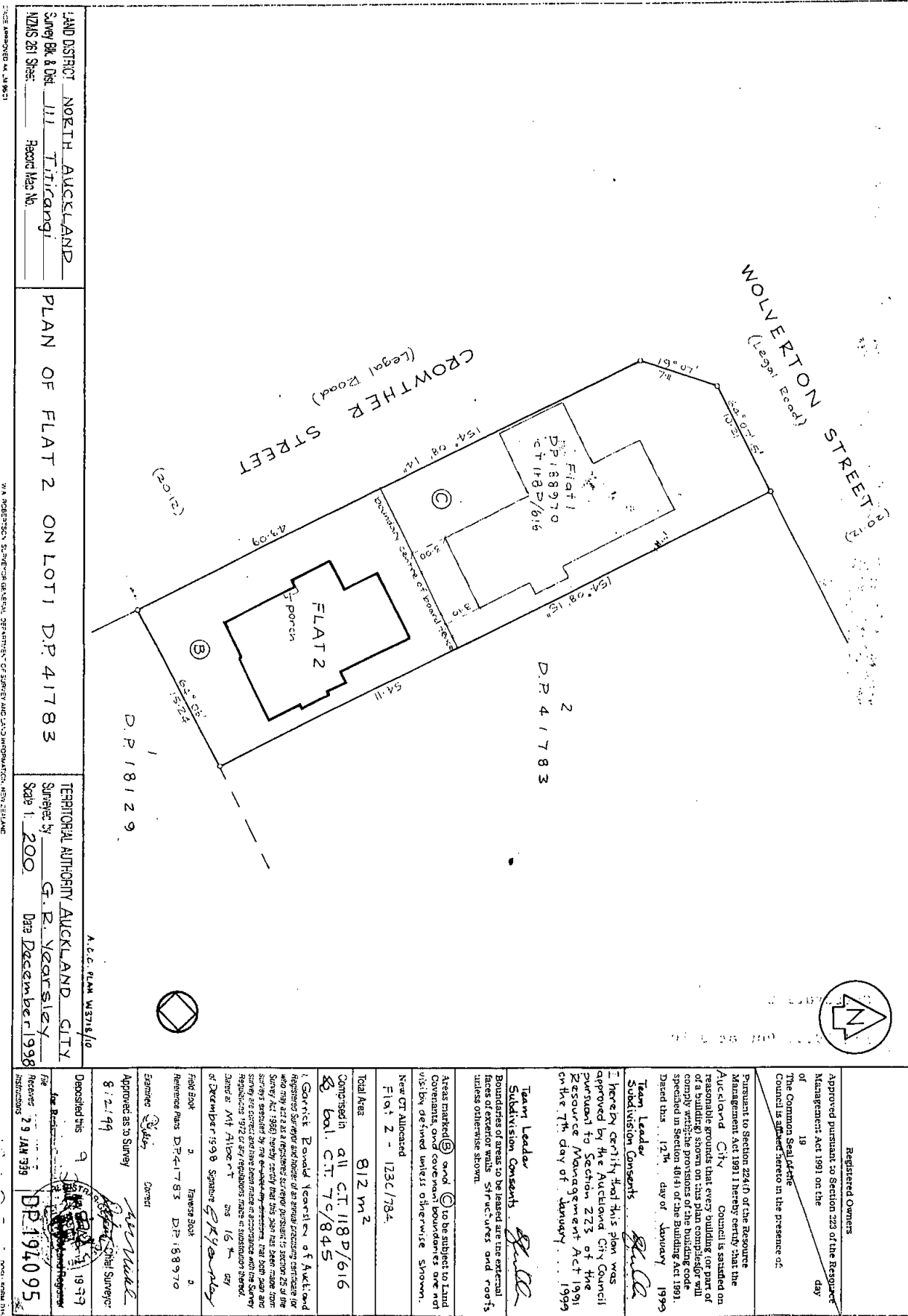

LAND DISTRICT NORTH AUCKLAND
 Survey Blk. & Dist. 111 Titirangi
 NZMS 261 Sheet: _____ Report Map No. _____

PLAN OF FLAT 2 ON LOT 1 D.P. 41783

TERRITORIAL AUTHORITY AUCKLAND CITY
 Surveyed by G. R. WARDLAW
 Scale 1:200 Date December 1998

A.C.C. PLAN M3718/10

<p>Registered Owners Approved pursuant to Section 223 of the Resource Management Act 1991 on the _____ day of _____ 19____ The Common Seal of the _____ Council is affixed hereto in the presence of:</p>	<p>Pursuant to Section 224(1) of the Resource Management Act 1991 I hereby certify that the Auckland City Council is satisfied on reasonable grounds that every building (or part of a building) shown on this plan complies with the provisions of the Building Code specified in Section 40(1) of the Building Act 1991. Dated this _____ day of _____ 1999</p> <p>Team Leader Subdivision Consents: _____</p> <p>I hereby certify that this plan was approved by the Auckland City Council pursuant to Section 223 of the Resource Management Act 1991 on the 7th day of January 1999</p>
<p>Team Leader Subdivision Consents: _____</p> <p>Boundaries of areas to be leased are the external boundaries of the lots, streets, wires and roots unless otherwise shown.</p> <p>Areas marked (B) and (C) to be subject to Land Covenants, and covenant boundaries are not visible, defined unless otherwise shown.</p> <p>New CT Allocated Flat 2 - 123C/784.</p> <p>Total Area 812 m² Composed in all CT 118D/616 & bal. CT: 7C/845</p>	<p>I, Garrett Donald Yearleson of Auckland Registered Surveyor and holder of an annual practicing certificate for who may act as a registered surveyor pursuant to section 25 of the Survey Act 1968, hereby certify that this plan has been made from surveys executed by me or by other persons, that such plans and reports were made in accordance with the provisions of the Survey Act 1968 and that the plan and reports are true and correct copies of the original plans and reports as made by me or by other persons in accordance with the provisions of the Survey Act 1968.</p> <p>Dated at Mt Alcock this 16th day of December 1998 Signature: _____ of December 1998</p> <p>Field Book: _____ Reference Plans: D.P. 41783 D.P. 18970</p> <p>Examined by: _____ Approved as to Survey: _____ Date: 21/99</p> <p>Deposited this 9th day of January 1999 Fee Received: 79 JAN 99 DP 194095</p>