



**RECORD OF TITLE
UNDER LAND TRANSFER ACT 2017
FREEHOLD
Search Copy**



R. W. Muir
Registrar-General
of Land

Identifier NA129A/111
Land Registration District North Auckland
Date Issued 17 March 2000

Prior References
NA62D/10

Estate Fee Simple
Area 1112 square metres more or less
Legal Description Lot 2 Deposited Plan 111364

Registered Owners
Joseph Matthew Emms

Interests

Fencing Agreement in Transfer 239839 (affects part formerly CT NA611/19)

STATEMENT OF PASSING OVER INFORMATION:

This information has been supplied to us by a third party. Accordingly, the Vendor and Austar Realty Limited are merely passing over this information as supplied to us by others. While we have passed on this information supplied by a third party, we have not checked, audited, or reviewed the records or documents and therefore to the maximum extent permitted by law neither the Vendor nor Austar Realty Limited or any of its' salespersons or employees accept any responsibility for the accuracy of the materials. Intending purchasers are advised to conduct their own investigation.

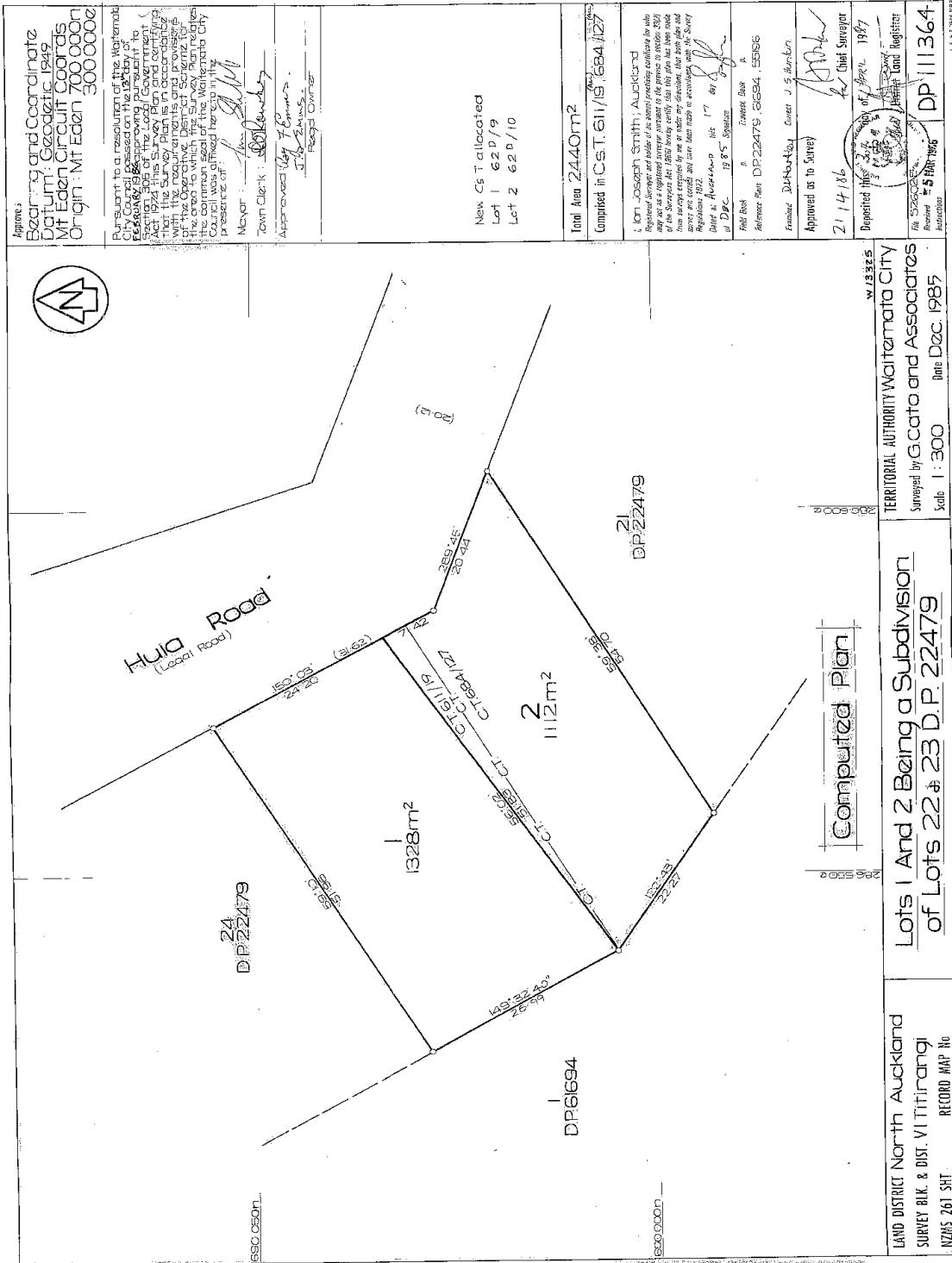

Approve:
 Bearing and Coordinate
 Datum: Geodetic 1949
 Mt Eden Circuit 700 0000
 Origin: Mt Eden 300 0000

Pursuant to a resolution of the Waitemata Council passed on the 15th day of October 1985, the following sections of the Local Government Act 1974, this Survey Plan and certificate with the requirements and provisions of the Geomatics District Scheme for the Waitemata District, and the Council was attached hereto in the presence of:

MAYOR: *[Signature]*
 Town Clerk: *[Signature]*
 Approved by: *[Signature]*
 Registered Owner

New Cs T. allocated
 Lot 1 62 P/9
 Lot 2 62 P/10

Total Area 2440m²
 Computed in C.S.T. 611/19 684/127

John Joseph Smith, Auckland
 Registered Surveyor and holder of the Surveying Certificate No. 100
 of the Surveyors Act 1974 hereby certify that this plan has been made
 from surveys executed by me or under my direction, that the area and
 bearings are correct and have been made in accordance with the Survey
 Act 1974.

Dated: Auckland 17th Dec 1985
 J. J. Smith
 1985 Signature

Field Book: *[Blank]*
 Reference Plan: DP 22479, 61694, 58186

Examined: *[Signature]* Surveyor J. S. Burrows
 Approved as to Survey: *[Signature]* Chief Surveyor

21 14 186
 Deposited this 23rd day of Dec 1985
 File 52600
 Received 23rd Dec 1985
 DP 111364

W. J. B. 1985

W. J. B. 1985
 TERRITORIAL AUTHORITY Waitemata City
 Surveyed by G. Cato and Associates
 Scale 1:300 Date Dec. 1985

LAND DISTRICT North Auckland
 SURVEY BLK. & DIST. VIITIRANGI
 NZMS 261 SH1
 RECORD MAP No

